

A grand gallery with red walls and classical art, equipped with professional film cameras and lighting rigs. The room features a high, vaulted ceiling with decorative elements and several large paintings in ornate frames. The floor is polished wood, and the furniture includes red upholstered chairs and a dark wooden table. Professional lighting equipment, including a large overhead light fixture and a camera on a tripod, is visible in the foreground.

FILMING & PHOTOGRAPHY

THE
WALLACE
COLLECTION



A UNIQUE FILMING LOCATION IN THE HEART OF LONDON

The Wallace Collection offers an exceptional filming location in the heart of London, combining historic grandeur with effortless practicality. Housed in the stunning Hertford House, its opulent galleries, sweeping staircases, and atmospheric period rooms provide an extraordinary backdrop for film, television, documentaries, and commercial productions. From glittering Rococo interiors to impressive armouries, the Collection offers a diverse range of settings that elevate any visual narrative.

With its central Marylebone location, the Wallace Collection is easily accessible for cast, crew, and equipment. Our experienced events and filming team provides dedicated support throughout the planning and shooting process, ensuring a smooth, efficient, and professional experience from start to finish. Whether you're seeking an elegant location for a period drama, a dramatic setting for editorial content, or a distinctive London venue with character and charm, the Wallace Collection delivers a unique, visually captivating environment for any production.

CONTENTS

This brochure provides an overview of filming and photography opportunities at the Wallace Collection. We have included imagery of all available gallery spaces to help you narrow down your preferred filming location and set out key information for you to refer to before your shoot.

Rate Card	4
Map of the Wallace Collection	5
Overview of Filming Locations	6-36
Photography Guidelines	39
FAQs	40
Contact Us	41

BASIC RATE CARD

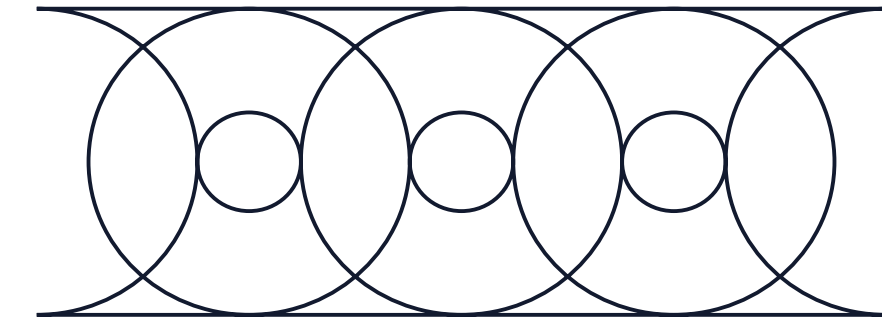

Crew Size (including talent)	Hourly Fee 08:00 -10:00 (only available on weekdays)	Hourly Fee 17:30 - 21:30 (minimum £1,500+VAT weekdays & £2,500+VAT weekends)	Hourly Fee 21:30 - 08:00 (minimum £1,500+VAT weekdays & £2,500+VAT weekends)
1-3	£300 + VAT	£400 + VAT	£600 + VAT
4-8	£400 + VAT	£500 + VAT	£700 + VAT
9-13	£600 + VAT	£700 + VAT	£1,000 + VAT
14-20	£700 + VAT	£800 + VAT	£1,250 + VAT
21-25	£800 + VAT (plus additional staffing costs)	£900 + VAT (plus additional staffing costs)	£1,350 + VAT (plus additional staffing costs)
25+	On Request	On Request	On Request

**Please consider the above costs as starting figures, all final costs will be subject to the specific requirements of each shoot.*

Additional requirements:

- Public Liability Insurance (PLI) of £10 million is required to confirm location hire at the Wallace Collection and proof of PLI will be required in advance of the shoot date.
- Full Risk Assessment for the shoot.
- Full kit list of shooting equipment being brought on site.

020 7563 9507/ 545/ 564
 events@wallacecollection.org
 wallacecollection.org/venuehire

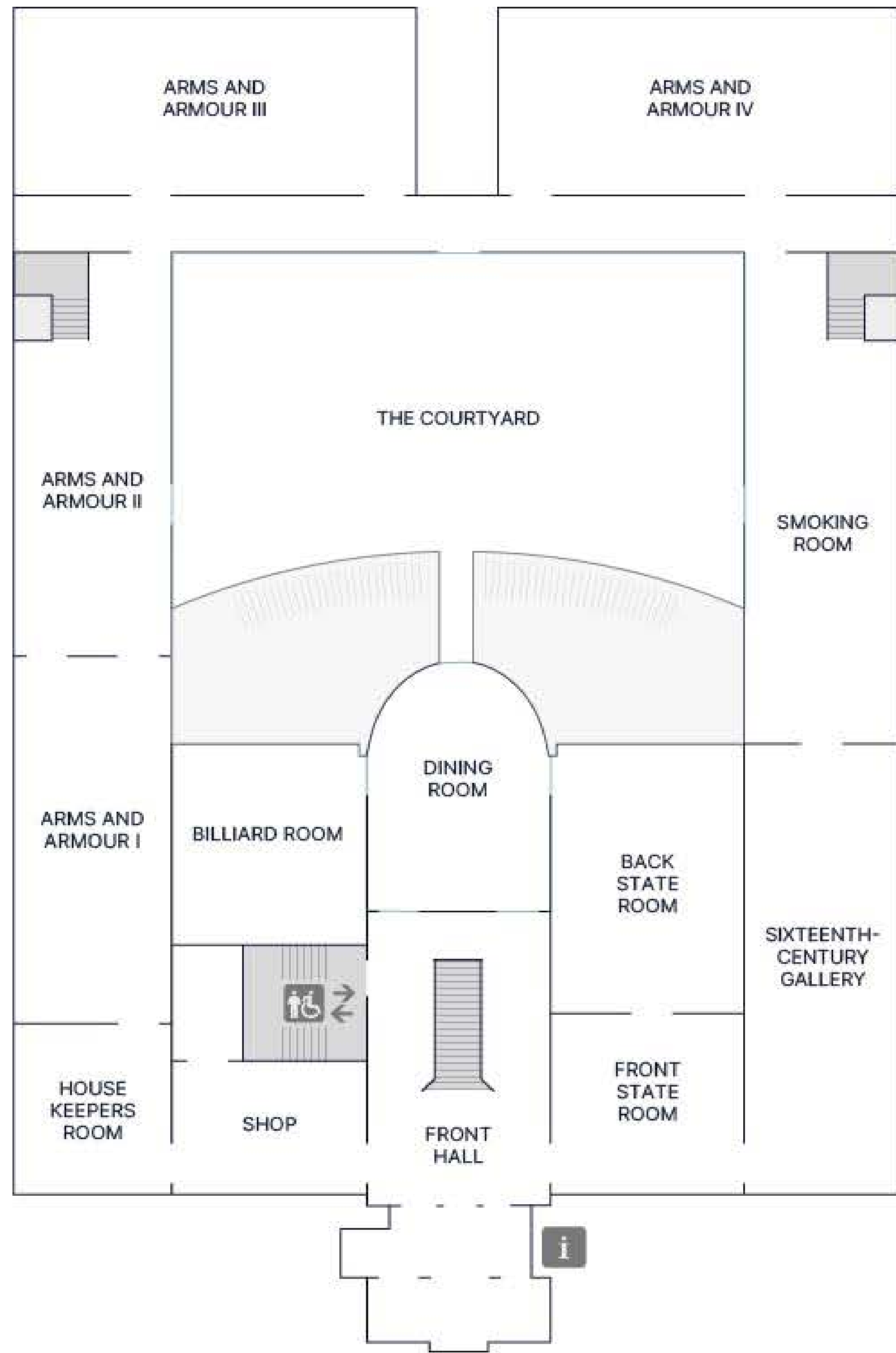

GROUND FLOOR

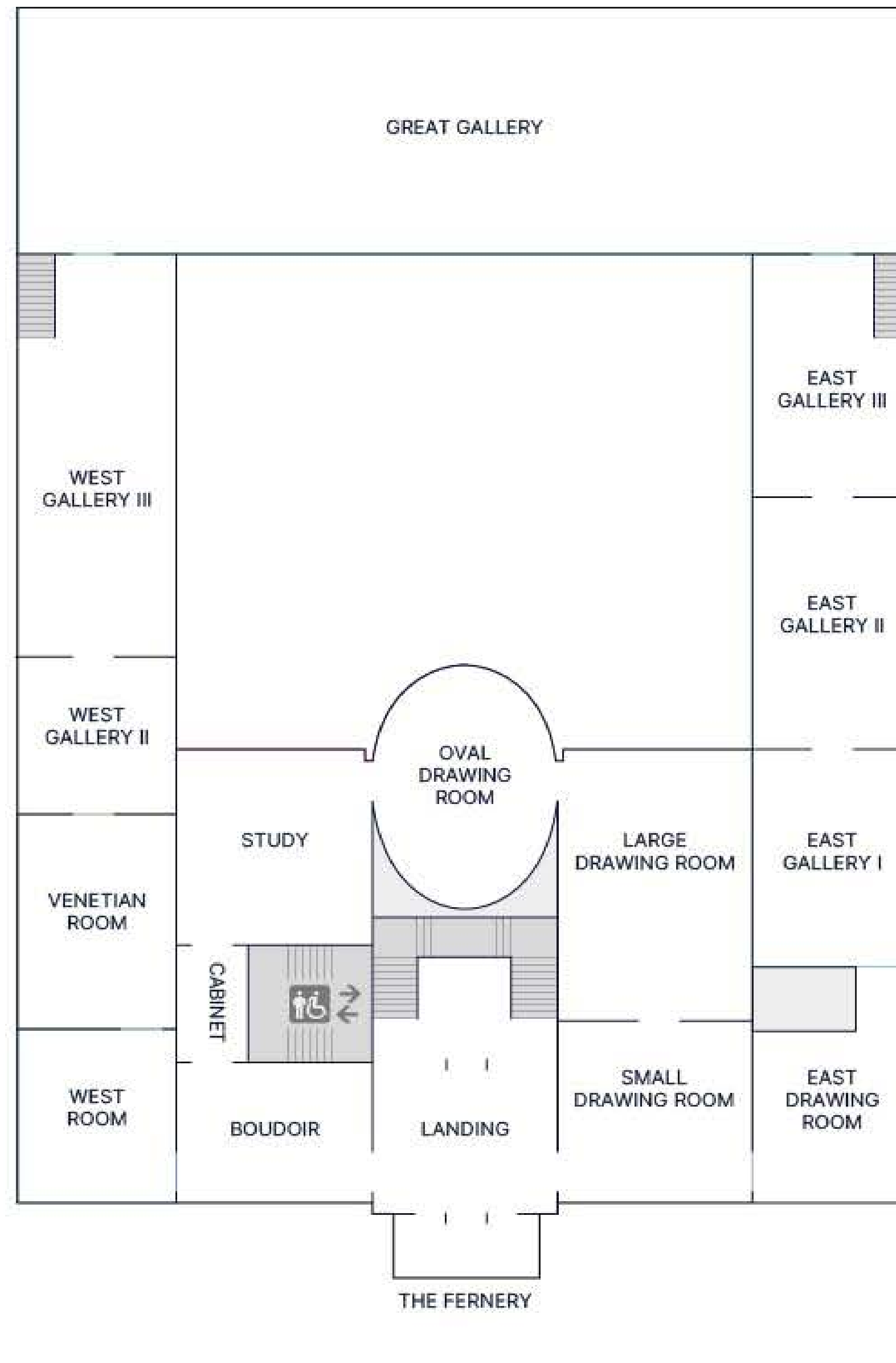

FIRST FLOOR

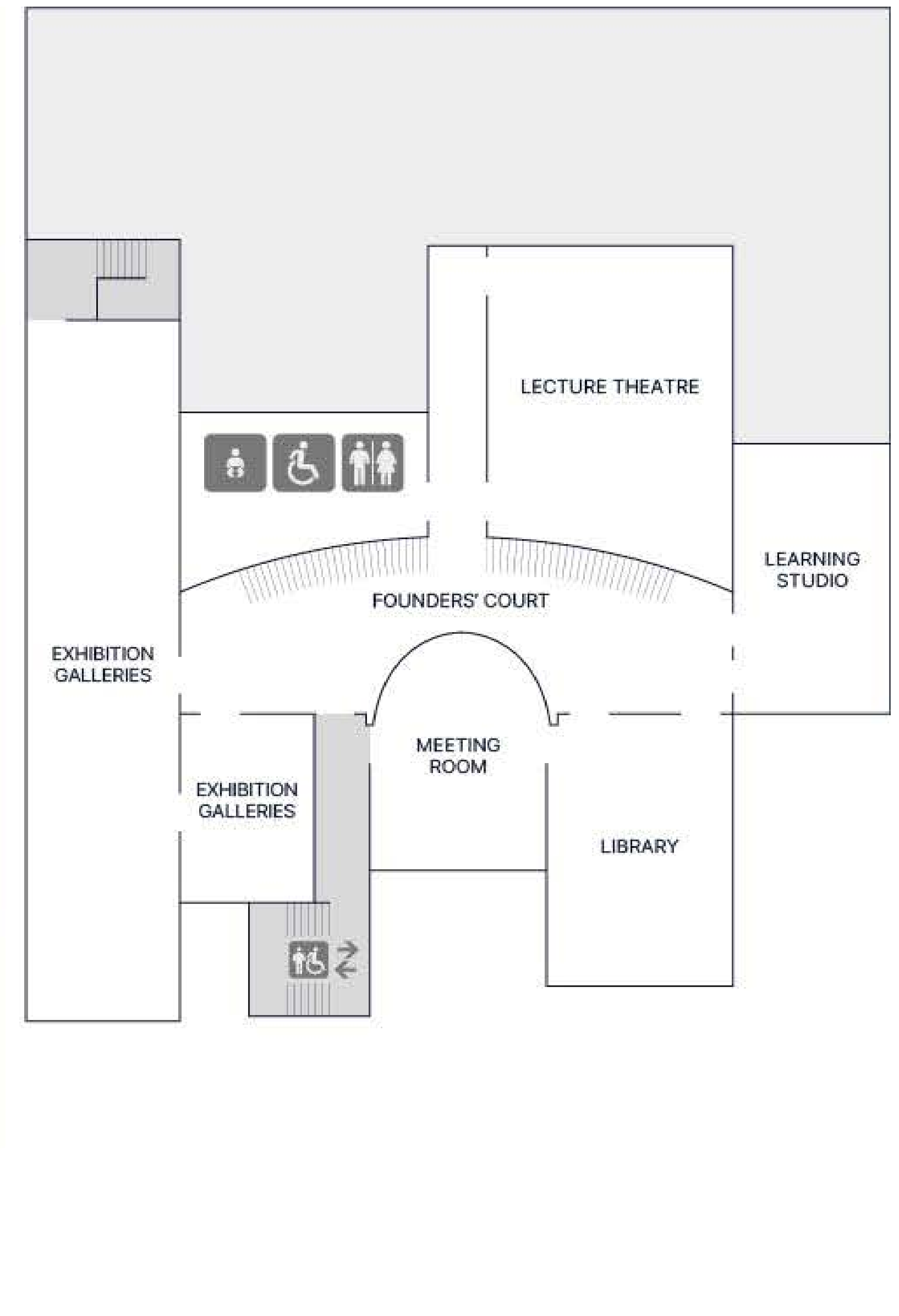

LOWER GROUND FLOOR



FRONT EXTERIOR

The front exterior features an elegant horseshoe driveway that sweeps around the front garden and passes beneath the portico, creating an ideal setting for filming arrival scenes while showcasing the grandeur of this stately home.

FRONT ENTRANCE

Ground Floor

Entering into the Wallace Collection, the grandeur of the collection beyond becomes apparent. Natural light pours into the entrance hall, complemented by a beautiful hanging chandelier that creates a warm and elegant atmosphere.



FRONT HALL

Ground Floor

The Front Hall embodies the grandeur of a stately home. Its magnificent staircase—relocated from the French Central Bank in 1874—creates a striking focal point and has long been a favourite among film crews. The exposed marble provides a timeless and elegant canvas.



THE LANDING

1st Floor

The Landing at the Wallace Collection provides a dramatic and versatile filming setting, distinguished by its sweeping staircase, elegant balustrades, and striking architectural grandeur. The space is crowned with a domed skylight.



THE FERNERY

1st Floor

The windows surrounding the Fernery bathe the space in soft, natural light, creating a serene and timeless backdrop. The recently restored mosaic floor adds a beautiful detail to any shoot.



SMALL DRAWING ROOM

1st Floor

The Small Drawing Room's manageable scale allows for controlled, discreet filming while still delivering in visual depth and sophistication.



LARGE DRAWING ROOM

1st Floor

Crowned by a glittering chandelier and furnished with exquisite pieces attributed to the celebrated cabinetmaker André-Charles Boulle, the Large Drawing Room exudes opulence and refinement.



OVAL DRAWING ROOM

1st Floor

The Oval Drawing Room is defined by its curved walls and natural light. Originally an entertaining space, the room's three windows look over the Courtyard below.



THE STUDY

1st Floor

The Study is dedicated to the taste and style of Marie-Antoinette, Queen of France. An exceptional group of furniture surrounded by Sèvres porcelain and other French Decorative arts, making it a truly distinctive filming location.



THE BOUDOIR

1st Floor

The Boudoir is an intimate, richly decorated room that reflects the elegance and refinement of 18th-century French interiors. Featuring artworks by Joshua Reynolds and Claude-Joseph Vernet, the room was originally a private sitting room.



EAST DRAWING ROOM

1st Floor

The East Drawing Room marks the start of the East Galleries, a selection of spaces celebrating the Collection's finest Flemish and Dutch paintings.



EAST GALLERY

1st Floor

The first of the three East Galleries, distinguished by their deep blue walls, showcases the work of the Dutch master Rembrandt van Rijn and the fellow artists of his time.



EAST GALLERY II

1st Floor

The second East Gallery explores the world of the Dutch Republic through domestic and genre scenes. Although on the surface most of these paintings depict orderly everyday life, they often conceal subtle, layered meanings beneath the surface.



EAST GALLERY^{III}

1st Floor

The final East Gallery features a rich array of paintings inspired by the light and landscapes of Italy. A long green bench lines the balustrade of the staircase, and through the symmetrical doorways, the galleries extend gracefully in view, creating a sense of depth and continuity.

THE GREAT GALLERY

1st Floor

The Great Gallery, displays the finest highlights of the collection, offering a stunning panorama of masterpieces—from Rembrandt to Rubens. Bathed in light from its impressive skylight, the magnificent space is able to accommodate large film crews.



THE WEST ROOM

1st Floor

Formerly the bedroom of Sir Richard and Lady Wallace, this gallery now showcases masterpieces of 18th-century British portraiture, with a notable focus on female sitters.



WEST GALLERY

1st Floor

Also known as 'the Venetian Room', the first of the three West Galleries is dedicated to the work of Canaletto and Francesco Guardi - the two outstanding Venetian view painters of the eighteenth century.



WEST GALLERY II

1st Floor

The second West Gallery houses works by the generation of British and French painters who came to maturity during the 1820s, following the Napoleonic Wars.



WEST GALLERY III

1st Floor

The final West Gallery is hung densely, as was customary during Sir Richard and Lady Wallace's day, with paintings by fashionable nineteenth century artists.



FRONT STATE ROOM

Ground Floor

This room encapsulates the opulence of the grand London townhouse in the 1870s. Originally designed to host the most distinguished visitors, the state rooms continue to impress and set the scene for today's guests.

BACK STATE ROOM

Ground Floor

This room is dedicated to the patronage of Louis XV of France and his lover, advisor and confidant Madame de Pompadour. It showcases some of the finest examples of Rococo art, a style that flourished under their guidance and taste.



DINING ROOM

Ground Floor

As its name suggests, the Dining Room was the formal room in which Sir Richard and Lady Wallace would take their meals. Today, it benefits from the natural light of the adjacent Courtyard which is accessed via a pair of elegant French doors.



BILLIARD ROOM

Ground Floor

The Billiard Room is a showcase for some of the best furniture of Andre Charles-Boulle and for the arts under Louis XIV of France. The golden silk walls, adorned by gold gilt furniture and frames provides a truly opulent setting.



16TH CENTURY GALLERY

Ground Floor

The 16th Century Gallery houses works of art from the Medieval and Renaissance periods. Central cabinets contain detailed miniatures and the west facing windows look out onto the Courtyard.



THE SMOKING ROOM

Ground Floor

The Smoking Room would once have been lined with the Iznik-style tiles preserved in the corner of the space. Today this room displays Sir Richard Wallace's collection of Italian Renaissance maiolica.

ARMS & ARMOUR I

Ground Floor

This gallery includes outstanding works from the Ottoman Empire, Iran, India, China and Ghana. Many of the objects were newly made when purchased and reflect the taste for 'exotic' works of art in Paris and London at the time.

ARMS & ARMOUR II

Ground Floor

This gallery displays some of the best-preserved medieval arms and armour in the world, alongside examples of the work of master Renaissance master armourers.

ARMS & ARMOUR III

Ground Floor

Kings, knights and aristocrats commissioned beautifully decorated weapons and armour for war, jousts, tournaments, hunting and parade. This room contains some of the most spectacular Renaissance examples preserved in the United Kingdom.



ARMS & ARMOUR IV

Ground Floor

Several of the weapons here were made for European rulers, including Louis XIII and Louis XIV of France and Nicholas I of Russia. It is considered one of the finest collections of early firearms in the United Kingdom.

FOUNDERS' COURT

Lower Ground Floor

The Founders' Court contains marble busts of the principal founders of the Wallace Collection: Richard Seymour-Conway, 4th Marquess of Hertford, Sir Richard Wallace and Lady Wallace, who bequeathed the Collection to the British nation.



LECTURE THEATRE

Lower Ground Floor

The Lecture Theatre offers a large back of house space with comfortable seating surrounded by original ornate gilt frames from the Collection.



MEETING ROOM

Lower Ground Floor

The Meeting Room also offers a useful back of house space. Food and Drink can be permitted in here for crew breaks.



THE LIBRARY

Lower Ground Floor

The wood-panelled library, offers a great background for documentary style shoots, or an academic setting.



PHOTOGRAPHY GUIDELINES AT THE WALLACE COLLECTION:

The Wallace Collection is a national museum, with small rooms and exposed works of art. We ask all photographers and crew members to take great care when working in the space. The below guidelines are in place to help you work safely in this historic environment:

General Behaviour

- Works of art must not be touched. Furthermore, they must not be moved or screened by the Official Photographer. Please advise your team not to rest belongings or equipment on any objects, or lean across any of the works of art in the Collection.
- Out of hours visitors to the Collection must be accompanied by a member of Wallace Collection Staff at all times. The Official Photographer must at all times take every reasonable care to ensure the proper and careful use of the Wallace Collection and take direction from Museum staff where given. Particular care should be taken when transporting or using equipment within the galleries.

Insurance

- Proof of public liability insurance must be shared with the event manager, prior to the shoot. Please also note, due to licensing, photography cannot solely focus on any works of art.

Lighting

- The light produced by flash photography can adversely affect paintings and other light sensitive objects in the Collection and directly lead to their deterioration. As such, the Wallace Collection does not allow static flash photography and we ask that the Official Photographer moves around the galleries to reduce the risk of over-exposure.
- Lighting should not shine directly onto works of art. Measures should be taken to switch off or cover lighting while filming is paused. LUX levels of lighting equipment must be provided to the Wallace Collection in advance.
- LED lighting should be used wherever possible. Lights that produce heat cannot be used under any circumstances. The Wallace Collection reserves the right to not permit lighting that produces heat at the location.

Equipment:

- The Wallace Collection Event Manager will ask for a list of equipment being bought on site in advance of the arranged time for your shoot. All electrical equipment that is bought on site must be PAT tested. We strongly encourage the use of battery powered equipment where possible. No electrical equipment can be plugged in anywhere without the permission of the Wallace Collection Event Manager.
- Please make sure cameras, lighting and other equipment are kept at least falling distance from all works of art (this includes furniture, wall coverings, mantelpieces, fire dogs etc.)
- There are guidelines in place for moving equipment safely within the collection. Equipment must never be carried at or above shoulder height. Equipment longer than six foot must be moved by at least two people, one at each end. Large items on wheels should also be moved by two people, one at each end.

FAQS

Is there a space for Hair and Makeup?

Touching up hair and make-up is not permitted within the galleries. If the Company requires an area for hair and make-up or if the Filming Personnel wish to use a steamer or other hot devices such as a hair dryer, this must be raised with the Wallace Collection's designated representative in writing in advance of the Filming Period. We are able to permit this activity in the Lower Ground Learning Studio.

Is there on-site parking?

Any parking required on site at the Location or vehicle access to the Location must be agreed with the Wallace Collection in writing in advance of the shoot. Please note that parking on site is limited. If vehicle access is granted by the Wallace Collection, then all vehicle registration details and driver details must be provided by the Company to the Wallace Collection's Representative by no later than noon the day prior to the start of the Filming Period.

Can we move objects during the shoot?

The Collection must not be moved or screened, except in exceptional circumstances where such arrangements have been agreed in writing with the Wallace Collection's Representative at least 30 days before the Shoot.

Can we bring in props for the shoot?

All props and set dressing equipment to be brought into the Location must be agreed in advance.

Is there somewhere we can safely store equipment throughout the shoot?

Yes, you are able to leave equipment unattended in the Courtyard at the centre of Hertford House.

Can we leave anything on-site in advance of the shoot?

As we are a National Museum open to the public throughout the day we are unable to keep any equipment on site. We ask that all equipment is brought with you and taken away during your agreed hire period.

CONTACT

Whatever your needs, our dedicated team are here to help you plan the perfect shoot:

The Events Department
The Wallace Collection
Hertford House
Manchester Square
London, W1U 3BN
020 7563 9507 / 545 / 564 / 546

Email: events@wallacecollection.org

Website: wallacecollection.org/venuehire

Instagram: [@wallacecollection_events](https://www.instagram.com/wallacecollection_events)

[Click here to sign up to our quarterly newsletter for the latest venue hire updates.](#)

